

# Mission briefing chart



F/A-18C TRAINING DAY

GENERAL INFORMATION								
CALLSIGN		DODGE 1		MISSION NUMBER		10-29NT_SP_MavT_FA18C		
WEATHER		32°C; QNH 790 / 31.10; QFE 709.26 / 27.92; BASE 2500; Sunshine						
AIRFIELD		A/B	TWR	ELEV,m	RWY	TIME		
	DEP	Nellis AFB	327.000	561	03R		06:45	
	ARR	Nellis AFB	327.000	561	21L		08:45	
	ALTN	Creech AFB	360.600	952	08		07:15	
FLIGHT		PILOT	A/C	LOADOUT		Task	FULE	
	Leader	DODGE 1	F/A-18C	View load chart!		Training	100%	
	WM1	-	-			-	-	
	WM2	-	-			-	-	
	WM3	-	-			-	-	
PACKAGE	N/A		A/C	VHF	UHF	D-Link	TASK	
	-		-		-	-	-	-
	-		-		-	-	-	-
	-		-		-	-	-	-
	-		-		-	-	-	-
WP	COORDINATE			NAME	ACTION	TIME	DIR	ELEV ft
0	Nellis AFB C01			ParkPos	GoIn	06:20	-	1843
1	Nellis AFB RWY 03R			RWY	Line-Up	06:45	03	1841
2				TakeOFF	TP	06:48	03	10000
3				WP3	TP	06:53	256	15000
4	Training begin		L O O P	EntryPoint	Electric ON	06:56	3	15000
5				ObsPoint	Scann	06:57	30	15000
6				IP	Weapon GO	06:59	339	15000
7				Return	TP	-	216	10000
8				WP4	TP	-	131	15000
9	Nellis AFB			Approach	TP	-	84	8000
10	Nellis AFB RWY 21R			RWY	TP	-	220	-
11								
12								
13								
14								
		IN	OUT	JOKER	BINGO	TOTAL	PLAYTIME	
FENCE	4   7		FUEL	2500	2000	10820	01:00	

## WP INFORMATION

MISSION NUMBER 20-xx

## Picture

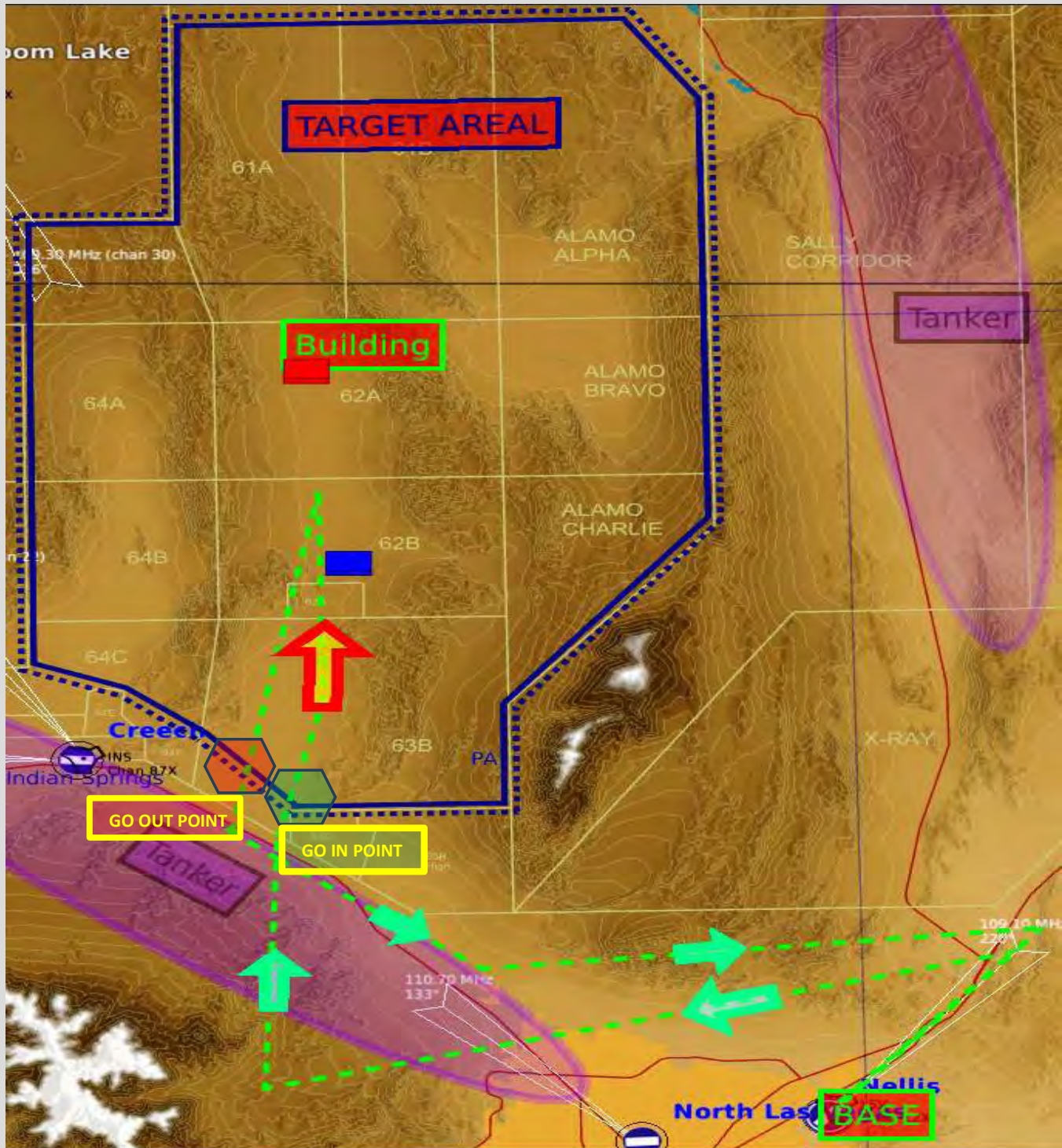



TACTICAL INFORMATION

MISSION NUMBER 20-2xNT\_MavT\_FA18C

TASK Maverick Training

Text / Picture

1. Switching on electrical equipment for ATFLIR and Maverick. WP 3
2. Search and scan for targets, Entry and Ops Point.
3. Angriff auf die Ziele
4. When all Mavericks have been fired, report Douglas 3!



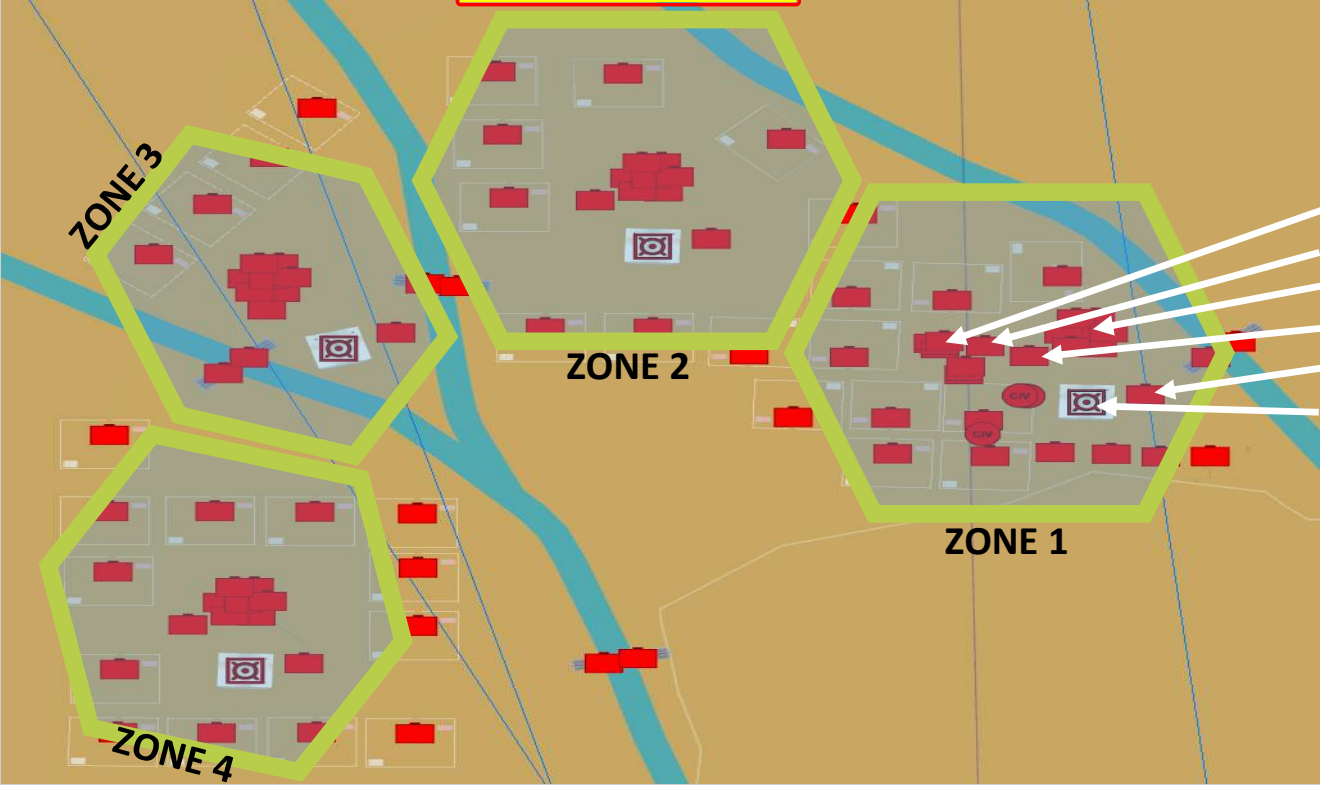



1. Fuel tank
2. Bunker
3. Antenna
4. Warehouse
5. Headquarters
6. Generator house

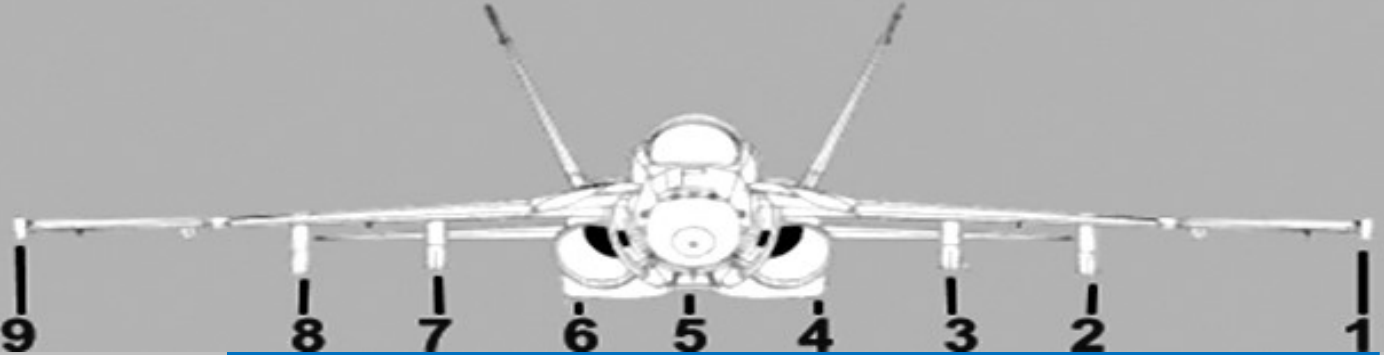

F/A-18C

LOAD INFORMATION

MISSION NUMBER	00-XX_MavT_FA18C	
NUMBER	123	
PARK POSITION	C04	
FUEL	20%	REFULE
LOAD	YES	

		
1	AN/ASQ-T50	
2	AGM-65F	
3	AGM-65F	
4	AN/ASQ-228	
5	X	
6	X	
7	AGM-65F	
8	AGM-65F	
9	AIM-9M	



AGM-65F  
IF

TNT 136 kg  
Kg 306  
Length 2,49 m  
Diameter 0,305 m  
Range 25 Km effektiv 6-9 km  
Infrared

ONLY IN ZONE 3 OR WITH LASERS!



AGM-65E  
Laser

TNT 136 kg  
Kg 293  
Length 2,49 m  
Diameter 0,305 m  
Range 20 Km  
Laser

RADIO | TACAN | ILS | INFORMATION

RADIO	COMM 1 and COMM 2		CHANNEL	WHAT		Mod
	251.000		1	Air Command		AM
	327.000		2	Nellis AFB		AM
	270.100		3	Nellis AFB ATIS		AM
	360.600		4	Creech AFB		AM
	290.450		5	Creech AFB ATIS		AM
	252.000		6	Tanker group 1		AM
	130.000		7	ADF JTAC group pos		AM
	132.000		8	ADF Air Command pos		AM
	150.000		9	EWR-NEVADA (Pinpoint)		FM
	136.000		10	JTAC 1 Axeman <b>Zone 1</b>		FM
	137.000		11	JTAC 2 Darknight <b>Zone 2</b>		FM
	138.000		12	JTAC 3 Warrior <b>Zone 3</b>		FM
	139.000		13	JTAC 4 Hammer <b>Zone 4</b>		FM
	45.000		14	Group channel		FM
TACAN	TACAN	WHAT	CODE	RADIO	CALLSIGN	TYP
	X 87	Creech AFB	INS	360.6		
	X 12	Nellis AFB	LSV	327		
	Y 1	Tanker 1 group 1		252	Texaco	KC-130
	Y 10	Tanker 2 group 1		252	Arcor	S-3B
	Y 11	Tanker 3 group 1		252	Shell	KC-135 MPRS
ILS	ILS	WHAT	CODE			

AIRPORT INFORMATION

NAME	Nellis AFB			MAP	Nevada	
TOWER	327.000	132.550	38.700			
TACAN	X 12	ADF	-			
		RWY				
ILS	109.10	21R	AWLS	1		

TAKE-OFF  
**03R**  
Landing  
**21R**

Park  
Position  
View load  
chart

TAXI TO  
**03R**  
VIA  
**C**  
**G**  
**A**  
LAST CHANCE  
TAKE-OFF

TAXI FROM  
**21R**  
VIA  
**B**  
CROSSING  
**03R**  
**B**  
**C**  
OR  
**A**  
**G**  
**C**

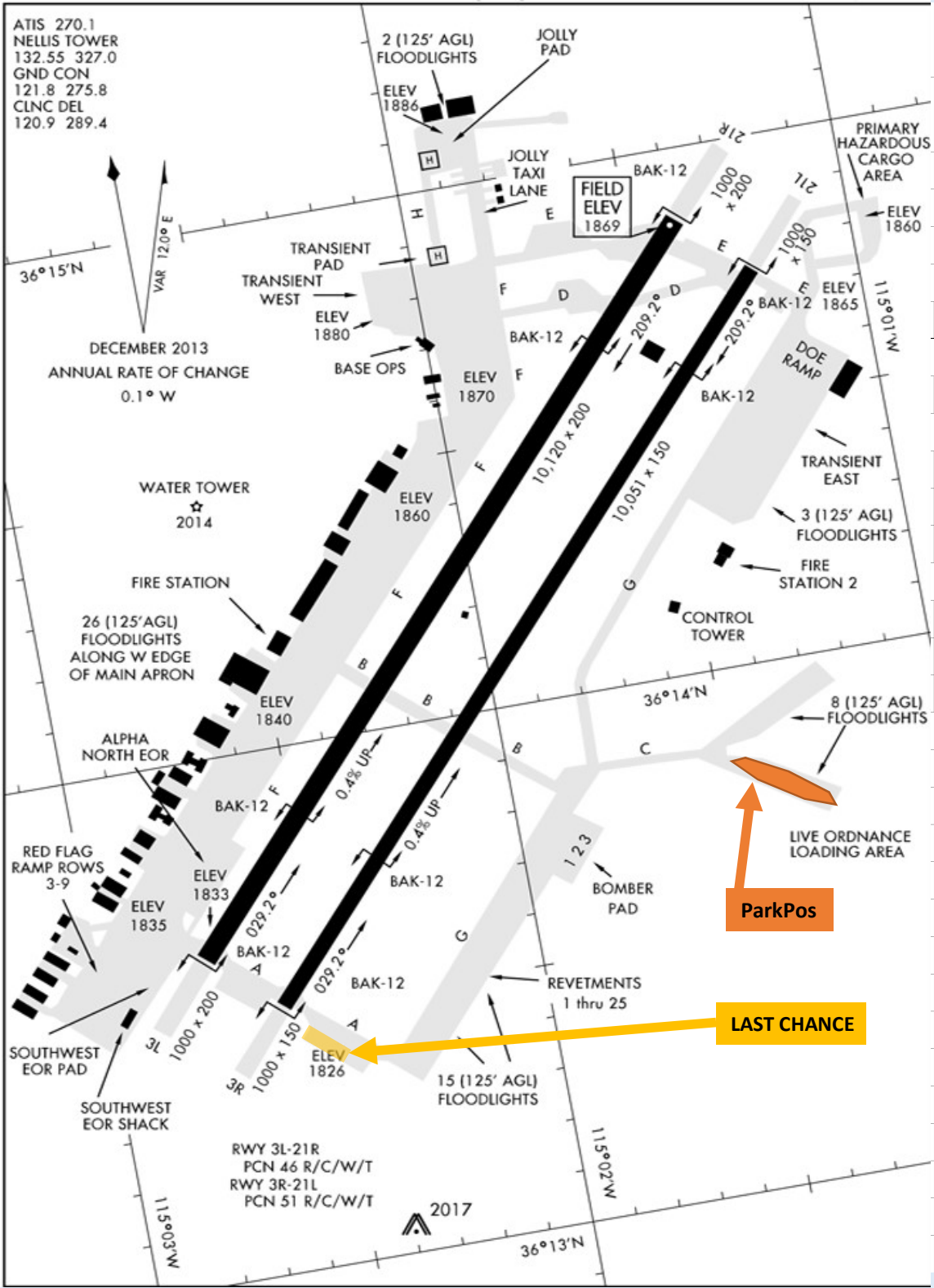



AIRPORT INFORMATION

NAME	Creech AFB			MAP	Nevada	
TOWER	360.600	118.300	38.550			
TACAN	X 87	ADF	-			
		RWY				
ILS	108.70	08	AWLS	2		

TAKE-OFF  
08  
Landing  
08

Park  
Position

TAXI TO	08
VIA	F
	C
	B
LAST CHANCE	
TAKE-OFF	

TAXI FROM	08
VIA	E
	B
Reload pos	

